

Scribe LCD Writing Tablet
Instruction Manual
ETA-SL20

READ ALL INSTRUCTIONS CAREFULLY BEFORE USE AND KEEP THIS MANUAL

In the Box

- ETA-SL20 Scribe LCD Writing Tablet (x1)
- User Manual (x1)

Safety Precautions

- This product is NOT a toy, keep away from children under 3 years and pets.
- Only use the device according to the instructions in this manual.
- Never use the device for anything other than its intended purpose.
- Do not open this product or attempt to repair the unit yourself if it is not working properly. Doing so risks fire, shock or injury.
- When not in use, the device should be stored in a dry, cool location, away from sources of water or heat.
- Do not expose device or power cable to extreme temperatures (heat or cold), open flames, humid or wet conditions.
- Do not submerge in water. Do not use in a location where the device or power cable could fall into liquid.
- Low battery may cause dysfunction.
- This device contains a battery and should not be disposed of with regular household waste. Please consult the local authorities on the correct way to dispose of this device.

Product

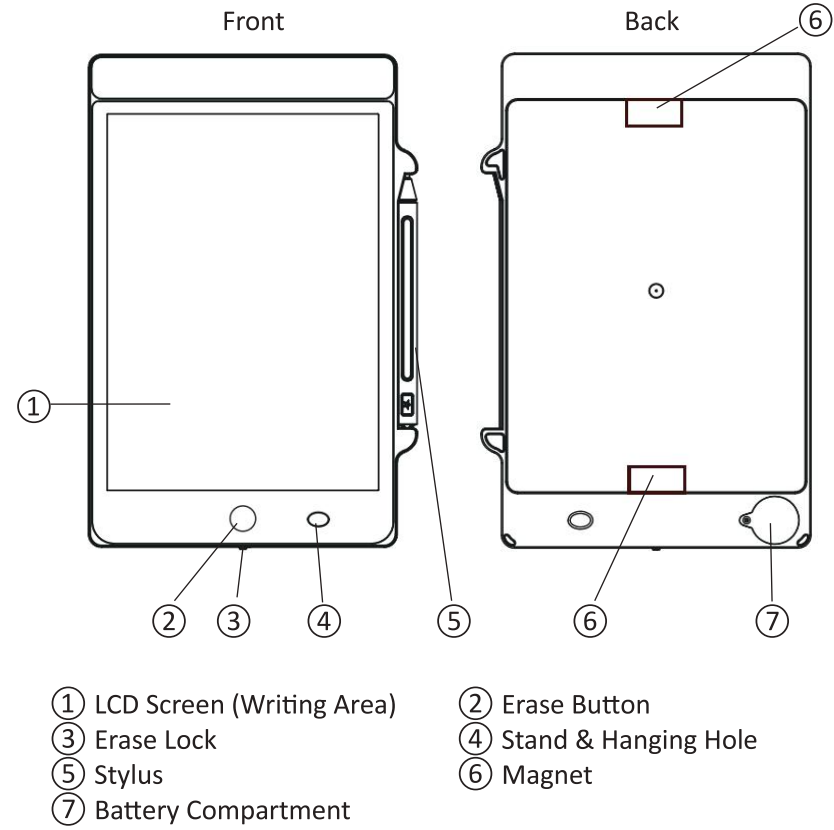

Using the Writing Tablet

- Detach the stylus from the side, and write or draw on the LCD screen.
(For best writing experience, please only use the included stylus with this writing tablet.)
- Switch the erase lock to ON or OFF to enable or disable the erase function.

- When the function is enabled, press the erase button on the front to erase entire screen.
- Insert stylus through stand and hanging hole to use as a stand.
- Use the magnet on the back to magnetically attach to fridge or any other flat steel surface.
- Hang tablet by using the stand and hanging hole directly, or inserting a string through the hole and securing.

Changing the Battery

- The writing tablet is powered by 1 x CR2016 button cell battery (included).
- Use a screwdriver to unscrew the battery compartment on the back and slide the battery compartment cover to the left to open.
- After the battery is replaced, put the battery compartment cover back in place and screw until secured.

Safety & Care

- Gently wipe the LCD screen with a soft cloth to clean.
- Do not press stylus too hard against the LCD screen.
- Do not use sharp objects on the screen.

FCC Information

This device complies with Part 15 of the FCC Rules.

Caution: Any changes or modifications not expressly approved could void the user's authority to operate the equipment.

Note: This equipment has been tested and found to comply with the

limits for a Class B digital device, pursuant to Part 15 of the FCC Rules. These limits are designed to provide reasonable protection against harmful interference in a residential installation. This equipment generates, uses and can radiate radio frequency energy and, if not installed and used in accordance with the instructions, may cause harmful interference to radio communications. However, there is no guarantee that interference will not occur in a particular installation. If this equipment does cause harmful interference to radio or television reception, which can be determined by turning the equipment off and on, the user is encouraged to try to correct the interference by one or more of the following measures:

- Reorient or relocate the receiving antenna.
- Increase the separation between the equipment and receiver.
- Connect the equipment into an outlet on a circuit different from that to which the receiver is connected.
- Consult the dealer or an experienced radio/TV technician for help.

This device complies with part 15 of the FCC rules. Operation is subject to the following two conditions (1) this device may not cause harmful interference, and (2) this device must accept any interference received, including interference that may cause undesired operation.



Made in China