

**TRIUMPH 3-IN-1 CHARGING CABLE
WITH 4-PORT USB HUB AND RECYCLED CASING
INSTRUCTION MANUAL
EAC-TR26**

READ ALL INSTRUCTIONS CAREFULLY BEFORE USE.

SAFETY PRECAUTIONS

- This product is NOT a toy, keep away from children and pets.
- Only use the device according to the instructions in this manual.
Never use the device for anything other than its intended purpose.
- Do not open this device or attempt to repair the unit yourself if it is not working properly. Doing so risks fire, shock or injury.
- When not in use, the device should be stored in a dry, cool location, away from sources of water or heat.
- Do not expose device to extreme temperatures (heat or cold), open flames, humid or wet conditions.
- Do not submerge in water. Do not use in a location where the device or charging cable could fall into liquid.
- Unplug the cable when not in use. Do not pull the cable to disconnect, or use the cable as a handle.
- Do not use if device or cable is damaged. If device or cable is damaged, it MUST be serviced or replaced by the manufacturer or its service agent before using again.

PRODUCT DIAGRAMS

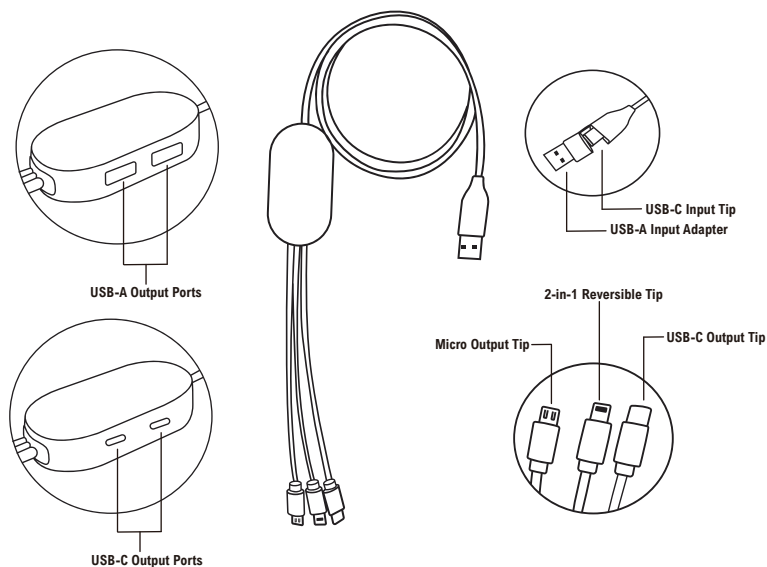

INSTRUCTIONS

- Make sure USB-A input adapter is inserted into USB-C input tip.
- Plug the USB-A input tip into any USB-A port on your device (e.g., laptop or PC).
- To connect an electronic device (like a keyboard, mouse, or flash drive), insert its USB-A tip into one of the USB-A output ports for charging or data transfer.

- Alternatively, connect the USB-C input tip to your computer's USB-C port. Then plug the USB-C tip of your device into a USB-C output port.
- This cable can also be used on its own to charge different devices.

USING THE 2-IN-1 REVERSIBLE TIP

- To use the 2-in-1 reversible tip, select the correct orientation of the tip to match your device's charging port:



For **Micro-USB Devices** you will insert the tip with the 5-PIN side of the cable facing up, as shown to the left.



For **iOS devices** with a lightning port (including iPhone models below 15 series), insert the tip of the side with no pins facing upwards, as shown to the left.

- Once connected properly, your device will start charging automatically.

FCC INFORMATION

This device complies with Part 15 of the FCC Rules.

Caution: Any changes or modifications not expressly approved could void the user's authority to operate the equipment.

Note: This equipment has been tested and found to comply with the limits for a Class B digital device, pursuant to Part 15 of the FCC

Rules. These limits are designed to provide reasonable protection against harmful interference in a residential installation. This equipment generates, uses and can radiate radio frequency energy and, if not installed and used in accordance with the instructions, may cause harmful interference to radio communications. However, there is no guarantee that interference will not occur in a particular installation. If this equipment does cause harmful interference to radio or television reception, which can be determined by turning the equipment off and on, the user is encouraged to try to correct the interference by one or more of the following measures:

- Reorient or relocate the receiving antenna.
- Increase the separation between the equipment and receiver.
- Connect the equipment into an outlet on a circuit different from that to which the receiver is connected.
- Consult the dealer or an experienced radio/TV technician for help.

This device complies with part 15 of the FCC rules. Operation is subject to the following two conditions: (1) this device may not cause harmful interference, and (2) this device must accept any interference received, including interference that may cause undesired operation.

